

**CHILDREN'S HOSPITAL OF SASKATCHEWAN
\$20 MILLION IN ADDITIONAL FUNDING
MEDIA BACKGROUND INFORMATION**

When the early design of the hospital was created in 2011, the original scope of the 152-inpatient bed maternal and children's hospital was based on the province's population projections at the time. Since then, Saskatchewan has hit an all-time high of over 1.1 million people living in the province, with the second highest growth rate among the 10 provinces in 2013, behind only Alberta.

Additional Beds:

A total of 176 private inpatient beds are now planned for the Children's Hospital of Saskatchewan with the addition of 24 inpatient beds. The information below outlines the changes from the initial design.

CHS Service Area	2011 Plan	2014 Updated Plan	Change
Pediatric Intensive Care Unit (PICU)	7	8	+1
Observation Unit	6	10	+4
Acute Care Pediatrics	40	45	+5
Maternal Patient Rooms	56	65	+9
Neonatal Intensive Care Unit (NICU)	43	48	+5
Total	152	176	+24

Potential Expanded Floor Plan:

The original design has the flexibility to incorporate the 24 new private patient rooms to the second, third and fourth floors, without having to re-design the entire building. This will increase the overall size of the hospital by 11 per cent or approximately 38,000 square feet.

The picture on the next page shows the area that is being considered on the third floor (maternal floor). This expansion area is able to support the addition of nine additional maternal care rooms with a slight re-configuration of layout while still supporting the floor's initial lean (3P) design principles of having many pregnant women labour, deliver, recover and stay with baby until leaving the hospital in the same room.

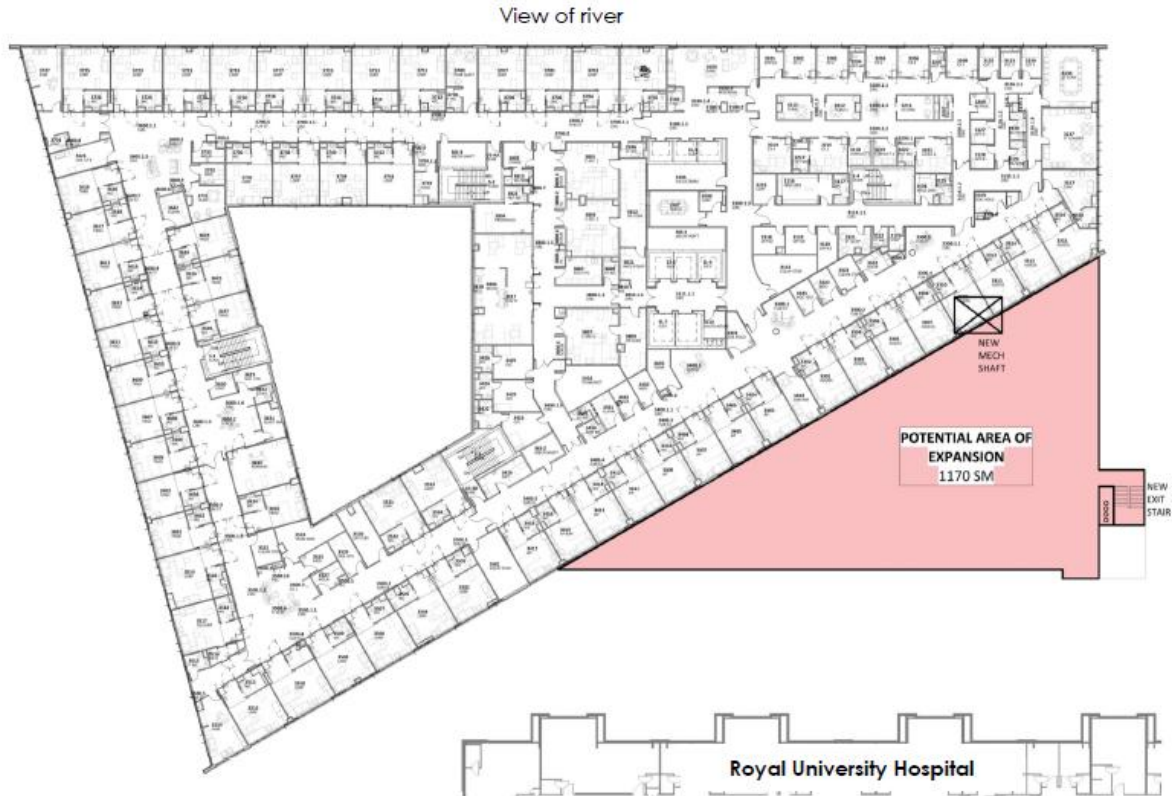

Project Next Steps:

Work continues to prepare the site at Royal University Hospital for hospital construction. This includes preparing a portion of the existing parking structure for demolition where the new hospital will be built. As well, work continues to complete the new entrance into Royal University Hospital's main floor mall from the parkade. Demolition of the portion of the parkade where the hospital will be built is slated to begin in spring 2014, with completion towards end of summer.

With the design of this expansion, the hospital's schedule has shifted by approximately five months. Construction is expected to start in September 2014 with the hospital scheduled to open in 2017.